

SEC. 20, T. 28 N., R. 4 E., W.M.

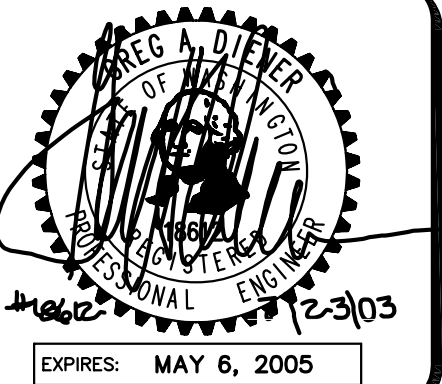

4180 LIND AVE. S.W.
RENTON, WA 98055
PHONE: (425) 251-8811
FAX: (425) 251-8880
WEB SITE:
PACENG.COM

Pacific
Engineering
Design, LLC

Civil Engineering and
Planning Consultants

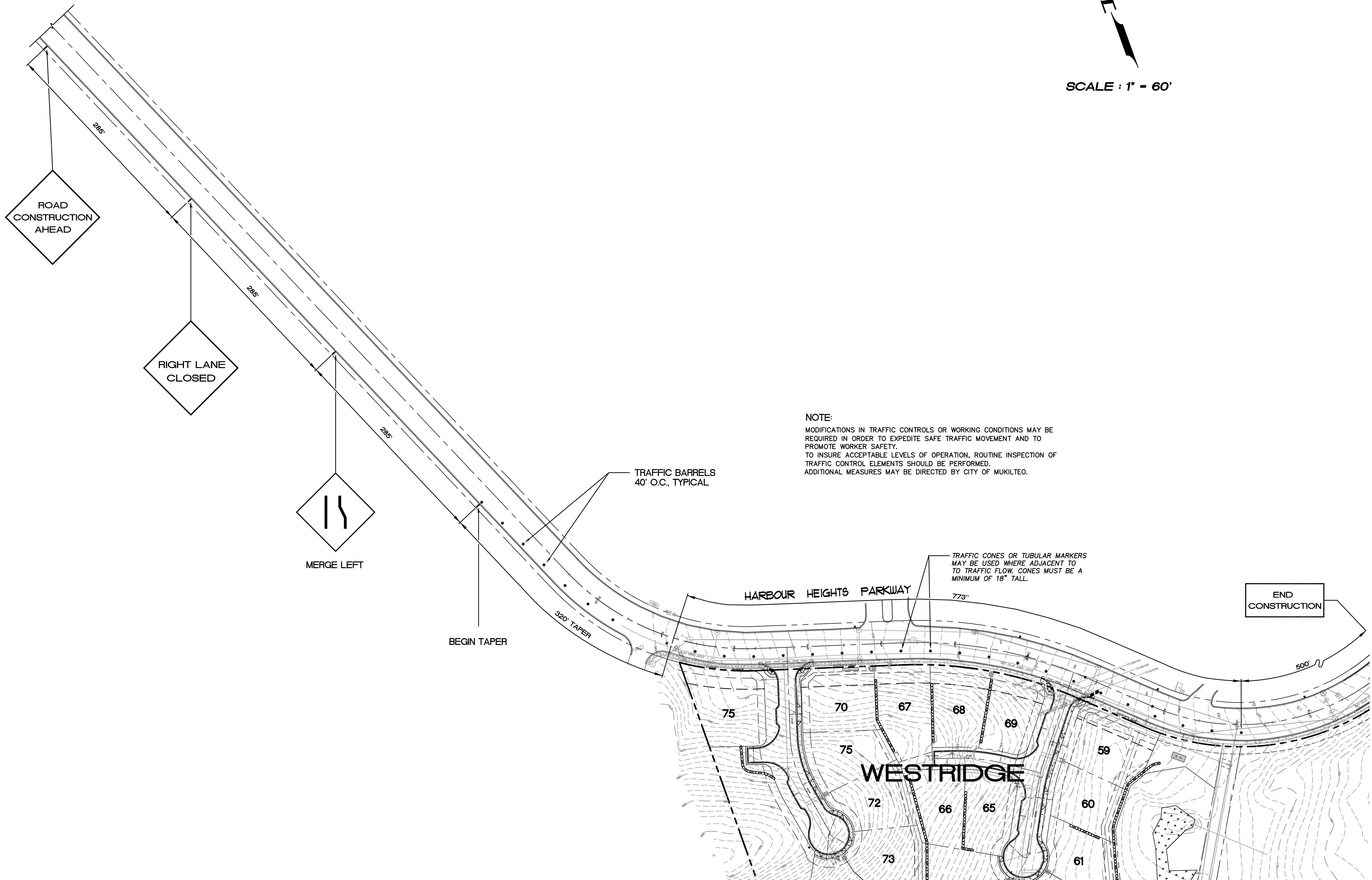
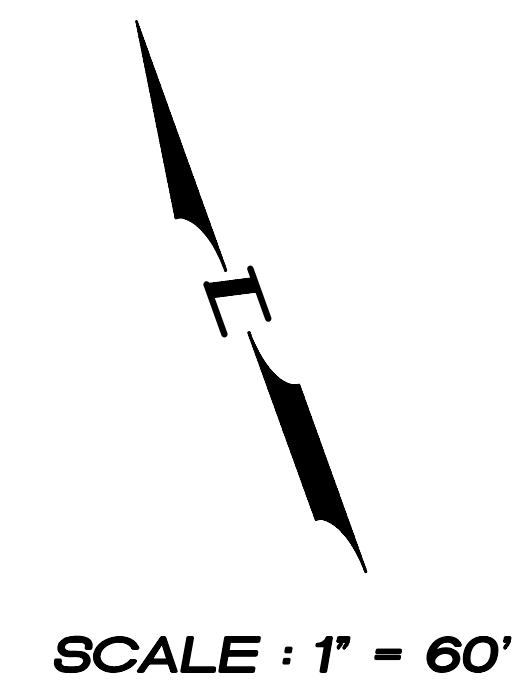

NOTE:
MODIFICATIONS IN TRAFFIC CONTROLS OR WORKING CONDITIONS MAY BE
REQUIRED IN ORDER TO EXPEDITE SAFE TRAFFIC MOVEMENT AND TO
PROMOTE WORKER SAFETY.
TO INSURE ACCEPTABLE LEVELS OF OPERATION, ROUTINE INSPECTION OF
TRAFFIC CONTROL ELEMENTS SHOULD BE PERFORMED.
ADDITIONAL MEASURES MAY BE DIRECTED BY CITY OF MUKILTEO.

WESTRIDGE (SECTOR 11 PHASE II)
MUKILTEO, WA

FOR
THE BURNSTEADS
125 120TH AVENUE NE, SUITE 201
MUKILTEO, WA 98147
PHONE: (425) 454-1800 FAX: (425) 454-4543

PROJECT NO.: 03002

DRAWN BY: TLR

ISSUE DATE: 07-23-03

SHEET REV.:

LANE
CLOSURE
EXHIBIT

03002EXH-LANE CLOSURE.DWG

C21